

Threaded pipe saddle "RAPIDO"

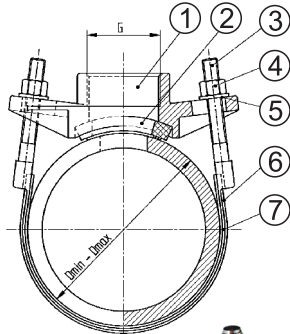

■ USE:

→ For use on cast iron, steel and asbestos cement pipes.

■ MATERIALS:

- 1 - body - ductile cast iron protected with epoxy powder coating,
- 2 - gasket - EPDM or NBR rubber,
- 3-5 - bolts, nuts and washers - stainless steel,
- 6,7 - straps - stainless steel with rubber protection.

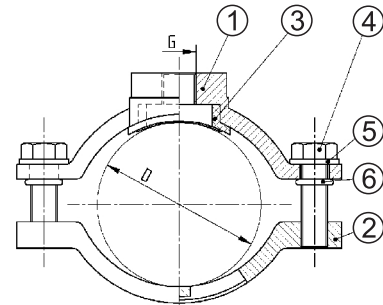

■ USE:

→ For use on pipes made of different materials.

■ MATERIALS:

- 1,2 - body - ductile cast iron protected with epoxy powder coating,
 - 3 - gasket - EPDM or NBR rubber,
 - 4,5 - bolts and washers - galvanized steel,
 - 6 - o - ring - EPDM or NBR rubber.
- Cylindrical thread according to ISO 228/1

The product has been certified as suitable for contact with potable water.

DN	Diameter [mm] Dmin - Dmax	Weight [kg]	Thread [G]	Number of straps	Product code	DN	Diameter [mm] Dmin - Dmax	Weight [kg]	Thread [G]	Product code
50	60 - 78	0,90	1" - 1½"	1		50	59 - 71	1,00	2"	
65	70 - 88	0,90	1" - 1½"	1		65	69 - 88	1,55	2"	
80	90 - 110	1,70	1" - 2"	1		80	88 - 109	1,23	2"	
100	100 - 130	1,80	1" - 2"	1		100	107 - 128	1,45	2"	
125	135 - 160	1,85	1" - 2"	1 or 2		125	132 - 152	1,60	2"	
150	160 - 185	1,90	1" - 2"	1 or 2		150	158 - 182	1,96	2"	
175	175 - 196	2,00	1" - 2"	1 or 2		200	217 - 234	2,20	2"	
200	210 - 245	2,20	1" - 2"	1 or 2		225	240 - 267	2,30	2"	
225	235 - 265	2,50	1" - 2"	1 or 2		250	270 - 288	2,50	2"	
250	260 - 305	3,20	1" - 2"	1 or 2		300	311 - 336	2,90	2"	
300	310 - 360	3,50	1" - 2"	1 or 2						
400	400 - 455	4,20	1" - 2"	1 or 2						
500	500 - 560	10,00	1" - 2"	2						
600	610 - 655	11,50	1" - 2"	2						